



Sockets 1/2", inch, extra deep

51a



Product no. **03420048**
GTIN **4018754008094**
Model **51 A 1**



Label. 1/2 " Socket Wrench size 1" L.83mm

Technical Drawing.

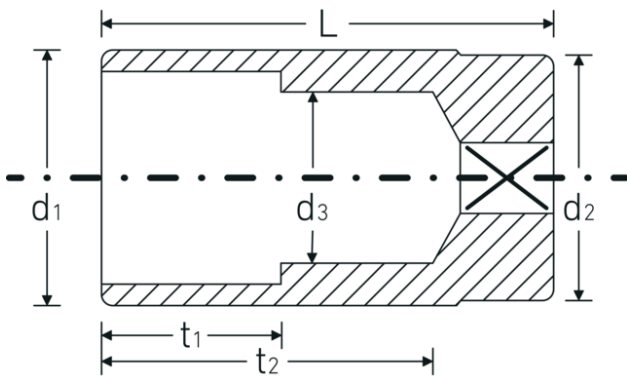

Technical Attributes.

| | |
|------------------------------|------------------|
| Drive profile | bi-hex AS-Drive® |
| Internal square drive (inch) | 1/2 " |
| d1 | 33,7 mm |
| d2 | 32 mm |
| d3 | 24,2 mm |
| Length mm (L) | 83 mm |
| Wrench size [inch] | 1 " |
| t1 | 35 mm |
| t2 | 65 mm |

Logistics data.

| | |
|----------------------|-------------|
| Depth mm (IFS) | 83 |
| Width mm (IFS) | 35 |
| Height mm (IFS) | 35 |
| Length (packed, mm) | 180 |
| Width (packed, mm) | 84 |
| Height (packed, mm) | 36 |
| Volume (packed, dm3) | 0.54432 dm3 |
| Product no. | 03420048 |
| Weight (gross, kg) | 1,325 |

| | |
|---------------------------|---------------------|
| Weight PAP (kg) | 0,000 |
| Weight PVC (kg) | 0,008 |
| GTIN | 4018754008094 |
| Country of origin | GERMANY |
| Region of origin | Nordrhein-Westfalen |
| WEEE/ElektroG | nicht ear-pflichtig |
| Customs tariff no. | 82042000 |
| Packing standard | 5 |
| Weight | 260 g |

Variants.

| Product no. | Model no. (ERP) | Description | GTIN |
|-------------|-----------------|---|---------------|
| 03420024 | 51 A 3/8 | 1/2 " Socket Wrench size 3/8" L.83mm | 4018754127108 |
| 03420028 | 51 A 7/16 | 1/2 " Socket Wrench size 7/16" L.83mm | 4018754127115 |
| 03420032 | 51 A 1/2 | 1/2 " Socket Wrench size 1/2" L.83mm | 4018754008025 |
| 03420034 | 51 A 9/16 | 1/2 " Socket Wrench size 9/16" L.83mm | 4018754008032 |
| 03420036 | 51 A 5/8 | 1/2 " Socket Wrench size 5/8" L.83mm | 4018754008049 |
| 03420038 | 51 A 11/16 | 1/2 " Socket Wrench size 11/16" L.83mm | 4018754008056 |
| 03420040 | 51 A 3/4 | 1/2 " Socket Wrench size 3/4" L.83mm | 4018754008063 |
| 03420042 | 51 A 13/16 | 1/2 " Socket Wrench size 13/16" L.83mm | 4018754127122 |
| 03420044 | 51 A 7/8 | 1/2 " Socket Wrench size 7/8" L.83mm | 4018754008070 |
| 03420046 | 51 A 15/16 | 1/2 " Socket Wrench size 15/16" L.83mm | 4018754008087 |
| 03420048 | 51 A 1 | 1/2 " Socket Wrench size 1" L.83mm | 4018754008094 |
| 03420050 | 51 A 1 1/16 | 1/2 " Socket Wrench size 1 1/16" L.83mm | 4018754008100 |
| 03420052 | 51 A 1 1/8 | 1/2 " Socket Wrench size 1 1/8" L.83mm | 4018754008117 |
| 03420054 | 51 A 1 3/16 | 1/2 " Socket Wrench size 1 3/16" L.83mm | 4018754127139 |
| 03420056 | 51 A 1 1/4 | 1/2 " Socket Wrench size 1 1/4" L.83mm | 4018754127146 |
| 03420058 | 51 A 1 5/16 | 1/2 " Socket Wrench size 1 5/16" L.83mm | 4018754127153 |
| 03420060 | 51 A 1 3/8 | 1/2 " Socket Wrench size 1 3/8" L.83mm | 4018754127160 |
| 03420062 | 51 A 1 7/16 | 1/2 " Socket Wrench size 1 7/16" L.83mm | 4018754127177 |
| 03420064 | 51 A 1 1/2 | 1/2 " Socket Wrench size 1 1/2" L.83mm | 4018754127184 |

GTIN-Code.

