

## Socket

51



Product no. **03020017**  
GTIN **4018754005611**  
Model **51 17**



**Label.** 1/2 " Socket Wrench size mm L.83mm

**Features.**

- long version
- bi-hex with AS-Drive profile
- 1/2" internal square drive
- size 16 mm-5/8", 20.8 mm-13/16": with rubber insert for spark plugs
- HPQ® high performance steel, chrome-plated
- DIN 3124 / ISO 2725-1 / DIN EN 3710 / DIN EN 3709 / ASME B 107.5M

## Advantages.

Long

## Technical Drawing.

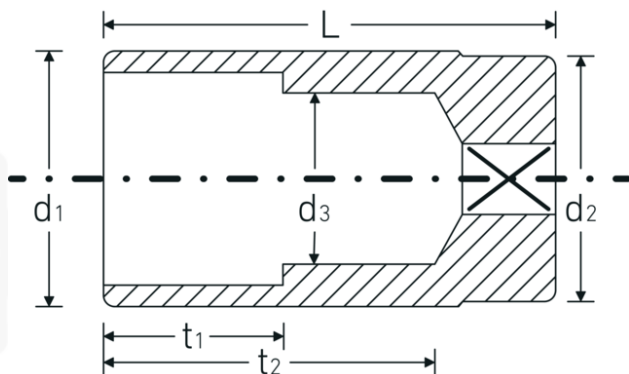

## Technical Attributes.

<b>Drive profile</b>	Bi-hex AS-Drive
<b>Internal square drive (inch)</b>	1/2 "
<b>d1</b>	24 mm
<b>d2</b>	23,7 mm
<b>d3</b>	16 mm
<b>DIN</b>	DIN 3124 / ISO 2725-1, DIN EN 3710, DIN EN 3709, ASME B 107.5M
<b>Length mm (L)</b>	83 mm
<b>Width across flats [mm]</b>	17 mm
<b>t1</b>	35 mm
<b>t2</b>	64,3 mm

## Logistics data.

<b>Depth mm (IFS)</b>	83
<b>Width mm (IFS)</b>	24
<b>Height mm (IFS)</b>	24
<b>Length (packed, mm)</b>	120
<b>Width (packed, mm)</b>	85
<b>Height (packed, mm)</b>	50
<b>Volume (packed, dm3)</b>	0.51 dm3
<b>Product no.</b>	03020017
<b>Weight (gross, kg)</b>	1,454
<b>Weight PAP (kg)</b>	0,000
<b>Weight PVC (kg)</b>	0,009
<b>GTIN</b>	4018754005611
<b>Country of origin</b>	GERMANY
<b>Region of origin</b>	Nordrhein-Westfalen
<b>WEEE/ElektroG</b>	nicht ear-pflichtig
<b>Customs tariff no.</b>	82042000
<b>Packing standard</b>	10
<b>Weight</b>	145 g

## Variants.

Product no.	Model no. (ERP)	Description	GTIN
03020010	51 10	1/2 " Socket Wrench size mm L.83mm	4018754167678
03020013	51 13	1/2 " Socket Wrench size mm L.83mm	4018754005574
03020014	51 14	1/2 " Socket Wrench size mm L.83mm	4018754005581
03020015	51 15	1/2 " Socket Wrench size mm L.83mm	4018754005598
03020016	51 16	1/2 " Socket Wrench size mm L.83mm	4018754005604
03020216	51 16-5/8	1/2 " Socket Wrench size mm/" L.83mm	4018754005741
03020017	51 17	1/2 " Socket Wrench size mm L.83mm	4018754005611
03020018	51 18	1/2 " Socket Wrench size mm L.83mm	4018754005628
03020019	51 19	1/2 " Socket Wrench size mm L.83mm	4018754005635
03020208	51 20,8-13/16	1/2 " Socket Wrench size mm/" L.83mm	4018754005734
03020021	51 21	1/2 " Socket Wrench size mm L.83mm	4018754005642
03020022	51 22	1/2 " Socket Wrench size mm L.83mm	4018754005659
03020024	51 24	1/2 " Socket Wrench size mm L.83mm	4018754005673
03020026	51 26	1/2 " Socket Wrench size mm L.83mm	4018754005680

03020027	51 27	1/2 " Socket Wrench size mm L.83mm	4018754005697
03020030	51 30	1/2 " Socket Wrench size mm L.83mm	4018754005710
03020032	51 32	1/2 " Socket Wrench size mm L.83mm	4018754005727

## GTIN-Code.

